

SOME MODELS REQUIRE A SMALL BULB: 'MINI GLOBE' 45x75mm RECOMMENDED FOR:
GEOMETRIC • SLIM GEOMETRIC • WIDE GEOMETRIC
DECORATIVE CHANDELIER • PENDANT • TUBULAR SLIM SNOWDROP PENDANT
• **RECOMMENDED MAXIMUM WATTAGE: LED BULB of 3w-8w •**

READ THIS BIT ASWELL
OUR OVAL LAMPSHADE
HAS VELCRO - TAKE CARE
WHEN RE-OPENING THAT
THE PAPER DOESN'T RIP.

HOW TO INSTALL

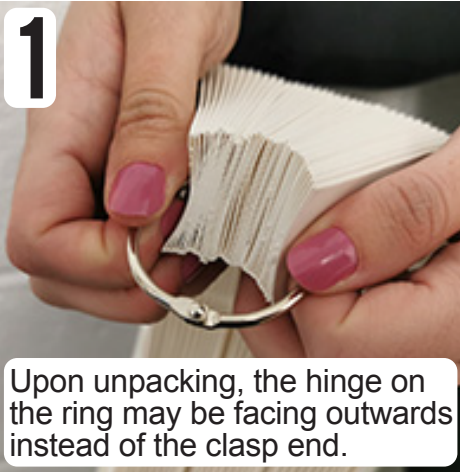

1
Upon unpacking, the hinge on the ring may be facing outwards instead of the clasp end.



2
Carefully feed the ring through the paper holes until the clasp end is facing outwards.



3
Try to get the clasp end as centre as possible so it's easier to open and fit.

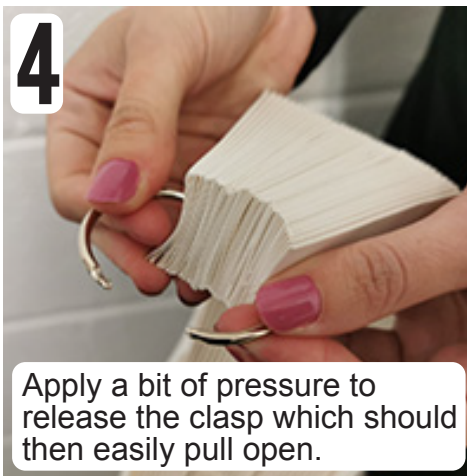

4
Apply a bit of pressure to release the clasp which should then easily pull open.



5
Place the open ring around the lamp cord just above the bulb fitting.

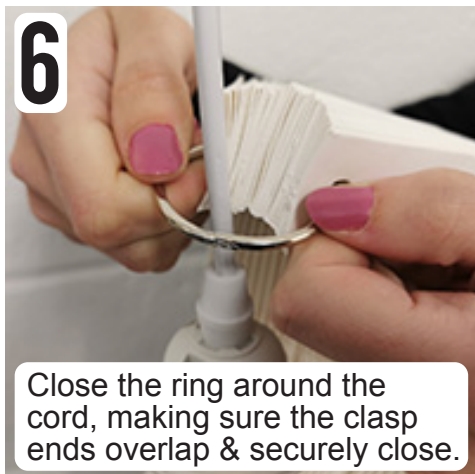

6
Close the ring around the cord, making sure the clasp ends overlap & securely close.



7
Lower the ring and shade as far down as it will sit on the centre of the bulb fitting.



8
Carefully open the shade around the bulb fitting paying attention to the top & bottom.

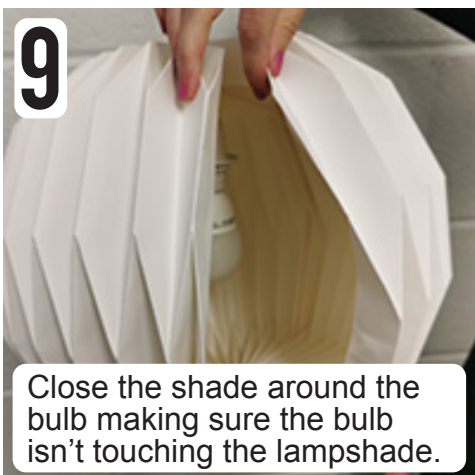

9
Close the shade around the bulb making sure the bulb isn't touching the lampshade.

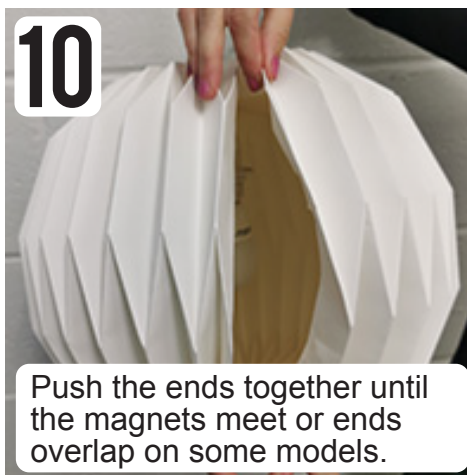

10
Push the ends together until the magnets meet or ends overlap on some models.



11
Check that ends have met or overlapped correctly, hide any joints & open any closed folds!